



MEDIA

LIVE

PASSIVE

SERVICE MANUAL

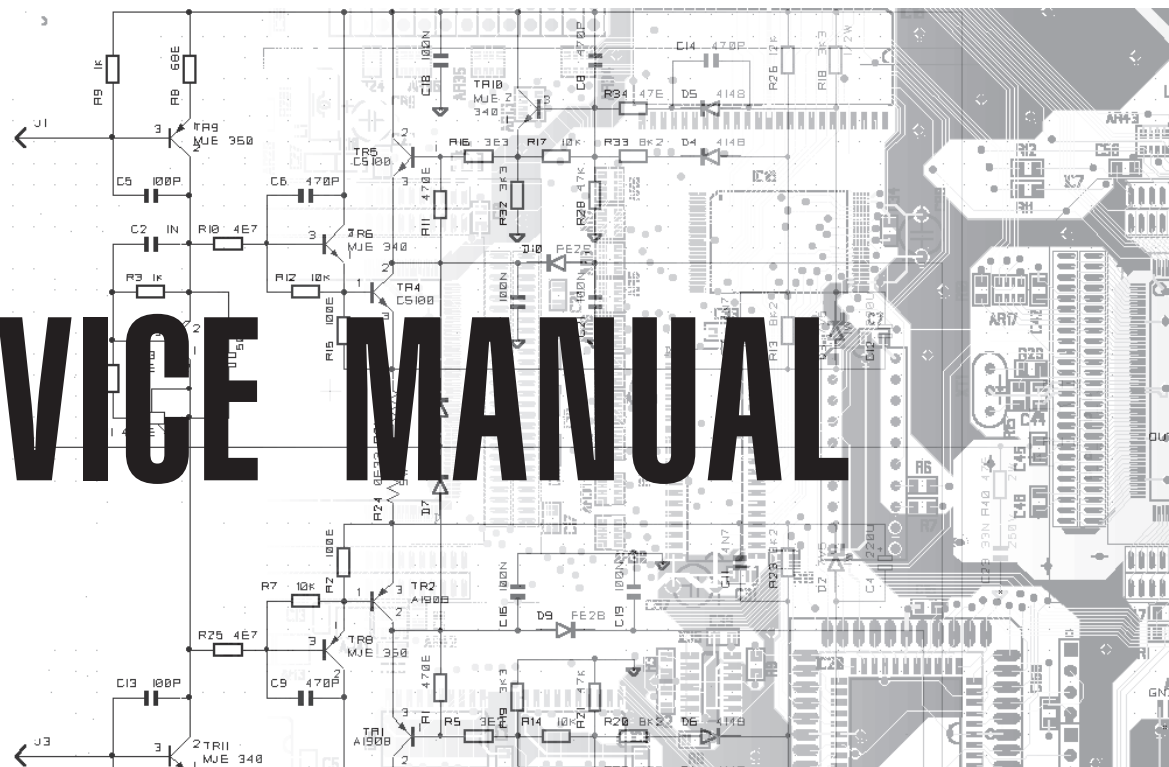

▲ CODE: 270220 ▼

Technical Specifications

TECHNICAL SPECIFICATIONS		SP-LIVE	SP-MEDIA
POWER	W (continuous)	90	
	W (max)	180	
IMPEDANCE	Ohms	8	
SENSITIVITY (SPL 1W/1m)	dB	95	91
MAX SPL	dB	119	115
FREQUENCY RESPONSE	Hz(-10dB)	85-20000	70-20000
CROSSOVER FREQUENCY	Hz	3,2kHz @ 12dB/ott.	
DISPERSION (OxV)	°	90x90	90x60
COMPONENTS		6"½ widerange	1"tweeter with EWT™ horn 6"½ woofer
CONSTRUCTION		Enclosure in polypropilene with mineral fibres and anti-scratch painting. Metal grid. 4 fixing points for SC accessories	
CONNECTIONS		2Jack + 2push terminal connectors (in parallel)	
DIMENSIONS	mm (LxAxP) in.(WxHxD)	194x300x251 7,6x11,8x9,8	
WEIGHT	Kg • lbs.	4,0 · 8,8	4,6 · 10,2

Warnings



Notice

Service must be carried out by qualified personnel only. Any tampering carried out by unqualified personnel during the guarantee period will forfeit the right to guarantee.

For a correct operation of the instrument, after having switched off, be careful to wait at least 3 seconds before switching on again.

To improve the device's specifications, the schematic diagrams may be subject to change without prior notice.

All components marked by this symbol have special safety characteristics, when replacing any of these components use only manufacturer's specified parts.

The (μ) micro symbol of capacitance value is substituted by U.

The (Ω) omega symbol of resistance value is substituted by E.

The electrolytic capacitors are 25Vdc rated voltage unless otherwise specified.

All resistors are 1/8Ω unless otherwise specified.

All switches shown in the "OFF" position. All DC voltages measured to ground with a voltmeter 20KOhm/V.

← Soldering point.

↑ Supply voltage.

⊥ Logic supply ground.

• Male connector.

□ Test point.

⊥ Analog supply ground.

○ Female connector.

◁ Flag joined with one or more flags

⊥ Chassis ground.

⚡ M/F faston connector.

with the same signal name inscribed.

⊕ Earth ground.



ATTENTION

Observe precautions when handling electrostatic sensitive devices.

Address

GENERALMUSIC S.p.A. Sales Division: 47842 S.Giovanni in Marignano (RN) ITALY - Via delle Rose, 12 - tel. 0541/959511 - fax 0541/957404
GENERALMUSIC on the NET: <http://www.generalmusic.com>

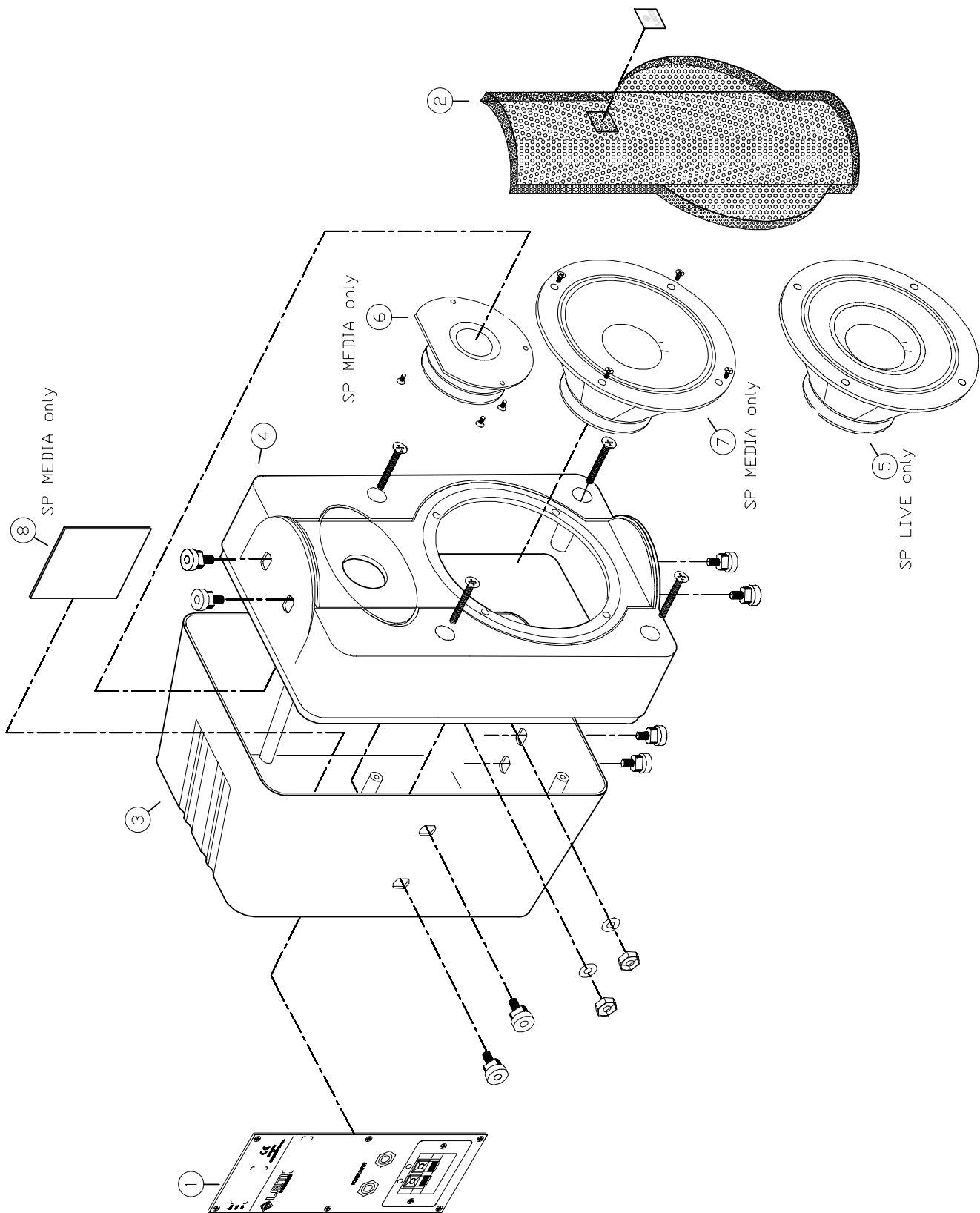

SOUND PRESSURE MEDIA

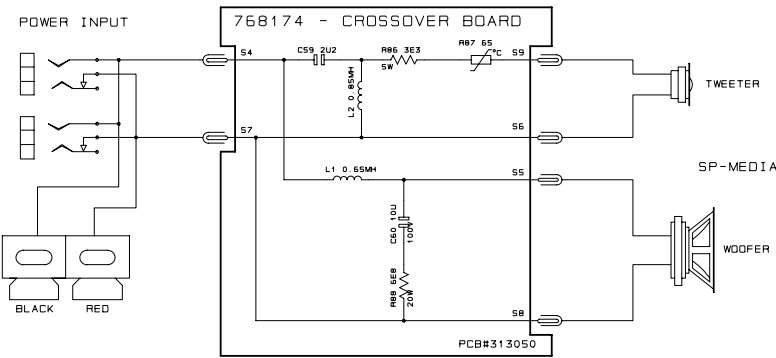

SOUND PRESSURE LIVE

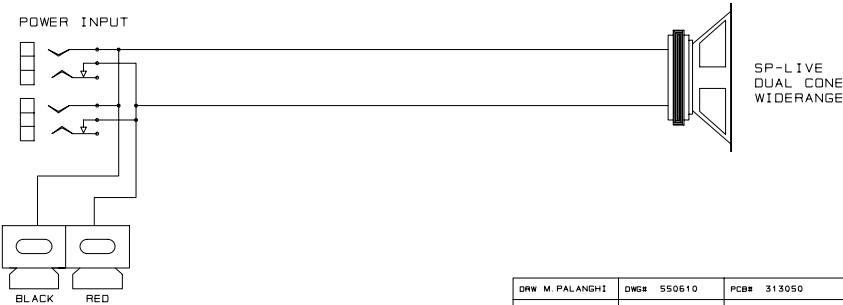

DRW: M. PALANGHI	DWG#: 550610	PCB#: 313050	GENERALMUSIC S.p.A. ITALY
CKD: G. RICCI	DSK#: 1/1 PART	SCHEMATIC DIAGRAM	
APP: C. ZUCCATTI	REV: 26-03-98	PASSIVE SOUND PRESSURE	MEDIA LIVE
ALL RIGHTS ARE RESERVED. NO COPIES OR REPRODUCTIONS OF THIS DOCUMENT WITHOUT WRITTEN CONSENT BY GENERALMUSIC.			

SPARE PARTS

Legend

SP-Live =Specify Live Version
SP-Media=Specify Media Version

Ref.	Code	Description
Optional Accessories		
951126	SC80 Flange for Telescopic stand and TOTEM system	
951127	SC81 Male Flange	
951128	SC82 Female Flange	
951131	SC85 TOTEM System Support	
950978	SC31 Telescopic Stand	
950444	SC61 Microphone Stand Adaptor	
950445	SC62 Wall Mounting Support	
950446	SC63 Table Fixing Clamp	
951125	SC64 T-Stand	

Accessories

277326	Owner's Manual
--------	----------------

Cabinet Assembly

1	667660	Input Panel
2	667662	Speaker Net
	667659	Threaded Fixing for External Supports
3	657257	Rear Shell
4	657255	Front Panel (SP-Live)
4	657254	Front Panel (SP-Media)
5	228014	8ohm 100W 6" Widerange Speaker (SP-Live)
6	229015	8ohm 20W 1" Dome Tweeter Speaker (SP-Media)
7	228013	8ohm 75W 6" Woofer Speaker (SP-Media)
	210229	Tweeter Gasket (SP-Media)
	210217	Black Sealer (specify mt)
	210209	Dacron Filler (specify mq)
	120603	M8 (UNI5588-65) Nut
	120471	8.4mm Washer

8	768174	Crossover Board (PCB#313050) (SP-Media)
The Service Support is made only by replacement the entire board		

Note:

Any request for not above mentioned part must encompass specific description including:

- 1) Model name,
- 2) Section name,
- 3) Module code,
- 4) Reference name,
- 5) Quantity number.